

SL10-
M2KTB-R

LED beacon | steady/flash | Ø100mm | 100-240V AC | terminal block | buzzer | red



Specifications

| | | | |
|---------------------------------------|-----------------------------------|-----------------------|---|
| Brand | Patlite | Operating temperature | -20°C to +50°C |
| Buzzer | Yes | Operating voltage | 90-250V AC |
| CE certificate | Yes | Particularities | Blinks 180x/minute or flashes 120x/minute |
| Cable length | 500mm | Rated current | 100V AC 0,09A / 240V AC 0,05A |
| Certificates, quality marks, markings | CE, cULus, EAC, KC | Rated voltage | 100-240V AC (50/60Hz) |
| Colour lens | Red | Relative humidity | Less than 90% (no condensation) at 20°C |
| Dimensions | Ø100mm x 146mm | Sound level (max) | 88dB |
| Impact resistance | 4,5G | Type | Pre-configured |
| Ingress protection | IP66 | UL certificate | Yes |
| LED life | 100 000h | Voltage | 115V AC / 230V AC |
| Light patterns | Steady, blinking and triple flash | Weight | 400g |
| Luminous intensity | 85cd | | |
| Material | Polycarbonate | | |
| Mounting and connection type | -30°C to +80°C | | |

Good to know

Standard light functions with flash settings typify this LED beacon. The newly developed Fresnel lens distributes uniform light from all surfaces of the dome, including the top.

■ SL10-M1KTB/SL10-M2KTB

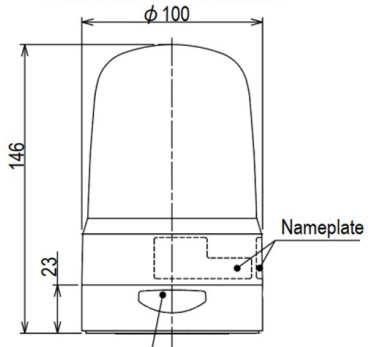

(Models with Buzzer Only)